

	TECHNICAL DATA	PORV UPGRADE KIT
---	----------------	------------------

The Viking Corporation, 210 N Industrial Park Drive, Hastings MI 49058
 Telephone: 269-945-9501 Technical Services: 877-384-5464 Fax: 269-818-1680 Email: techsvcs@vikingcorp.com

Notice: The PORV Upgrade Kit provides the D-3 or D-4 PORV and the required fittings to upgrade existing conventional deluge trim that utilized the C-1 PORV. Each kit includes the necessary fittings to install the D-3 or D-4 PORV onto any size Straight Through or Angle Style Deluge Valve.

There will be fittings included in the kit that are not required for certain valve installations. Consult Tables 1 and 2, and Figures 1-4 for details.

Part Numbers:

For Angle Style Valves: Galvanized - 14869-1, Brass - 14869-2

For Straight Through Valves: Galvanized - 14870-1, Brass - 14870-2

Table 1 - Quantities for Upgrade Kit 14869-1 and 14869-2 for Right Angle Valves						
Description	Quantity required from the kit for installation					Quantity Provided in Kit
	1-1/2" Trim	2" Trim	3" Trim	4" Trim	6" Trim	
1/2" x Close Nipple	1	1	-	-	-	1
1/2" x 1-1/2" Nipple	2	2	2	2	2	2
1/2" x 2" Nipple	1	1	1	1	1	1
1/2" x 2-1/2" Nipple	1	1	2	1	-	2
1/2" x 3-1/2" Nipple	-	-	-	-	1	1
1/2" x 4-1/2" Nipple	-	-	-	1	-	1
1/2" x 7" Nipple	-	-	-	-	1	1
1/2" Elbow	3	3	3	3	3	3
1/2" Union	1	1	1	1	1	1
PORV	1	1	1	1	1	1

Table 2 - Quantities for Upgrade Kit 14870-1 and 14870-2, for Straight Through Valves											
Description	Quantity required from the kit for installation										Quantity Provided in Kit
	Vertical Trim					Horizontal Trim					
	1-12" & 2" Trim	2-1/2" & 3" Trim	4" Trim	6" Trim	8" Trim	1-12" & 2" Trim	2-1/2" & 3" Trim	4" Trim	6" Trim	8" Trim	
1/2" x Close Nipple	2	2	2	1	4	1	1	2	1	3	4
1/2" x 1-1/2" Nipple	3	3	3	3	1	4	4	3	3	1	4
1/2" x 2-1/2" Nipple	-	-	-	1	-	-	-	-	1	-	1
1/2" x 4" Nipple	2	2	1	1	1	1	1	1	1	-	2
1/2" x 4-1/2" Nipple	-	-	1	1	1	-	-	1	1	-	1
1/2" x 5" Nipple	-	-	-	-	-	-	-	-	-	1	1
1/2" x 5-1/2" Nipple	-	-	-	-	-	1	1	-	-	-	1
1/2" x 6" Nipple	-	-	-	-	-	-	-	-	-	1	1
1/2" Elbow	2	2	2	2	2	2	2	2	2	2	2
1/2" Union	2	2	2	2	2	2	2	2	2	1	2
PORV	1	1	1	1	1	1	1	1	1	1	1



TECHNICAL DATA

PORV UPGRADE KIT

The Viking Corporation, 210 N Industrial Park Drive, Hastings MI 49058

Telephone: 269-945-9501 Technical Services: 877-384-5464 Fax: 269-818-1680 Email: techsvcs@vikingcorp.com

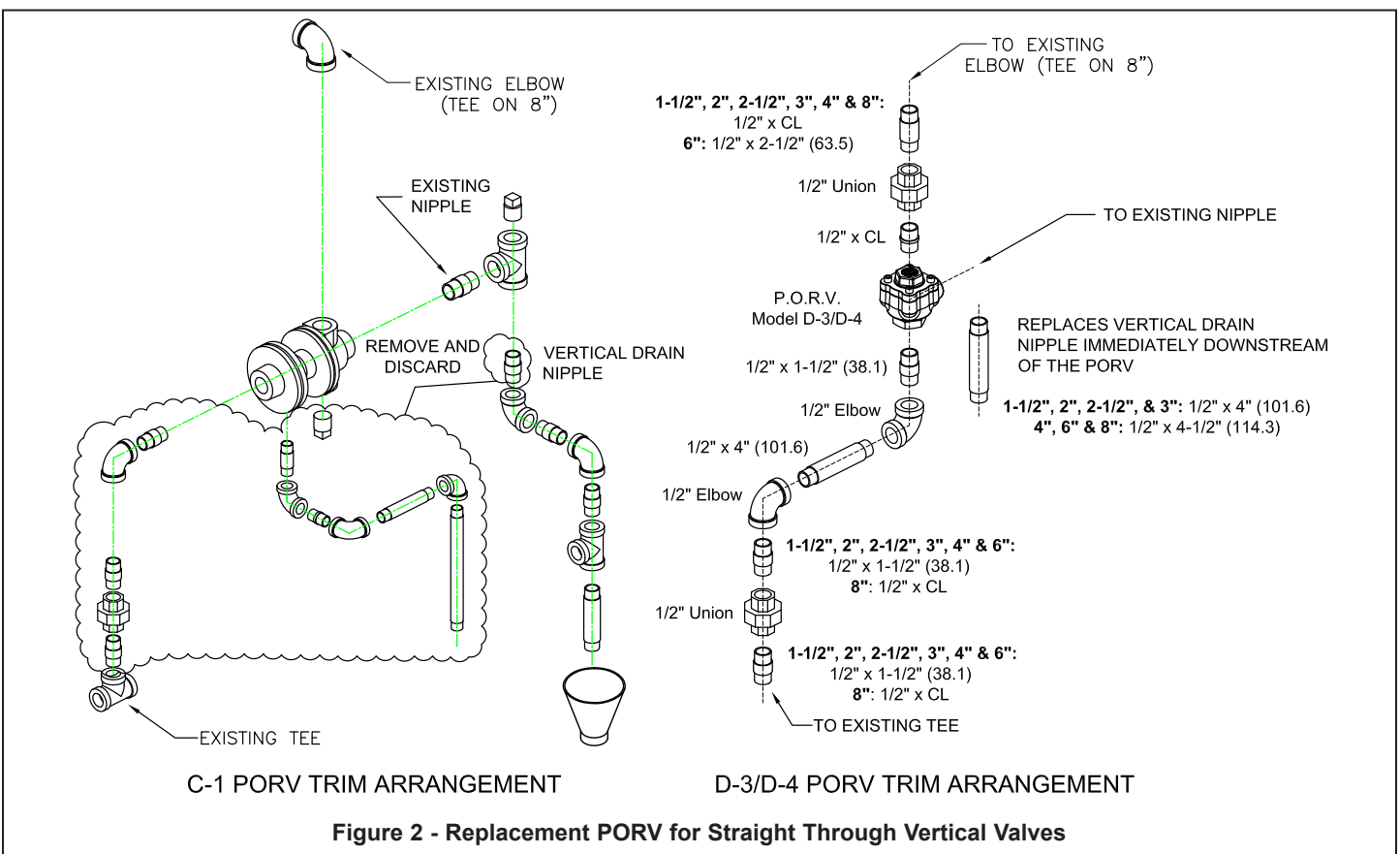
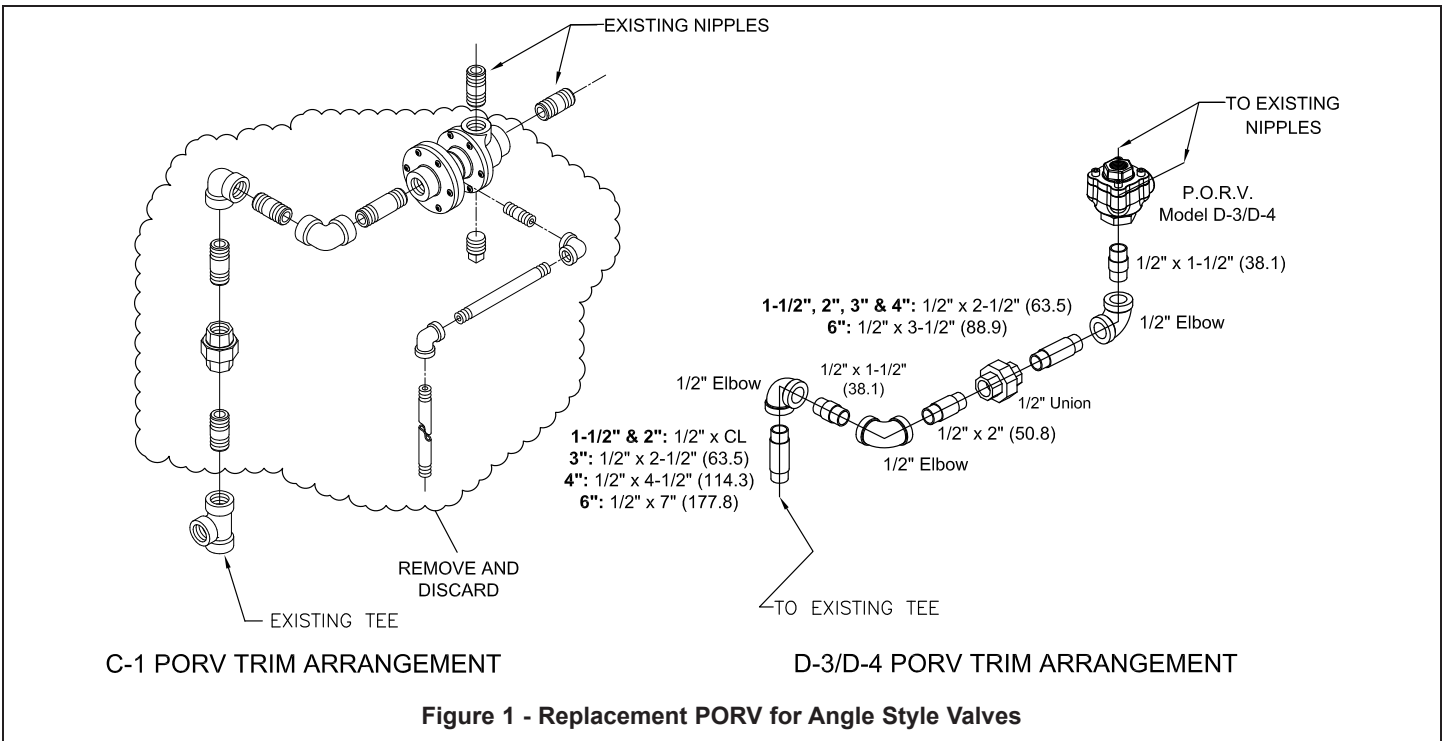



TECHNICAL DATA

PORV UPGRADE KIT

The Viking Corporation, 210 N Industrial Park Drive, Hastings MI 49058

Telephone: 269-945-9501 Technical Services: 877-384-5464 Fax: 269-818-1680 Email: techsvcs@vikingcorp.com

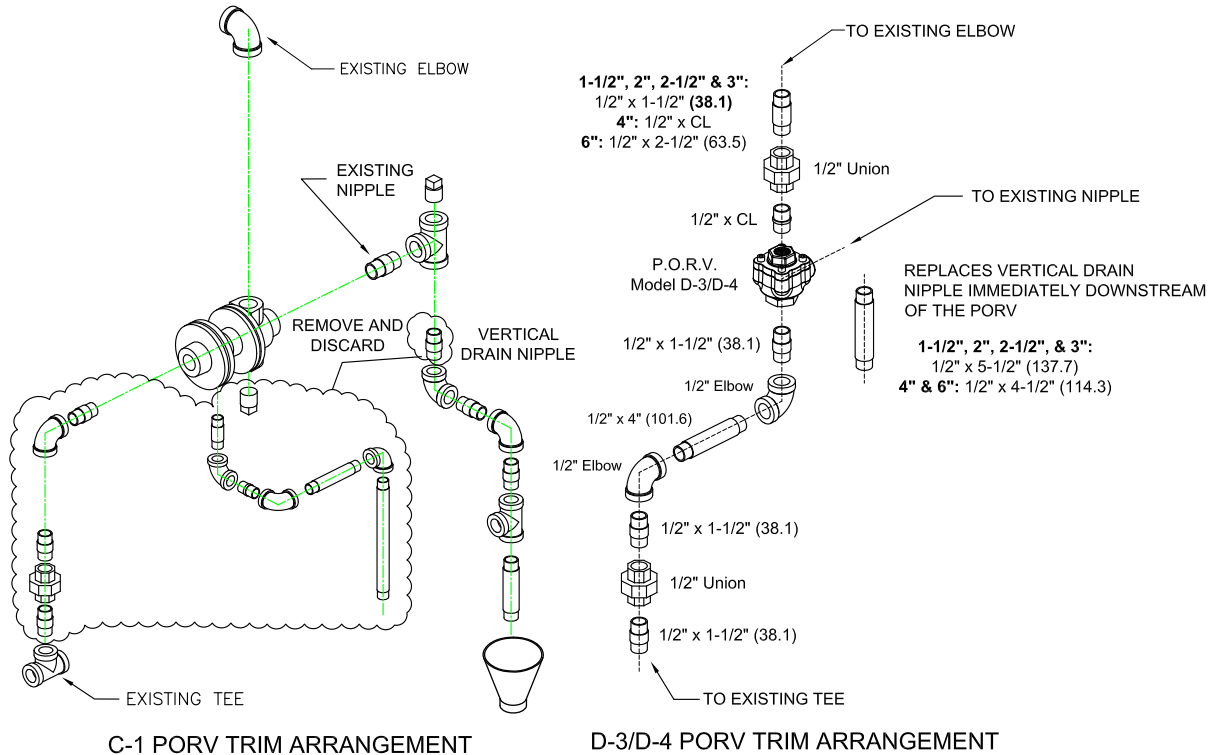

Figure 3 - Replacement PORV for Straight Through Horizontal Valves, Excluding 8"

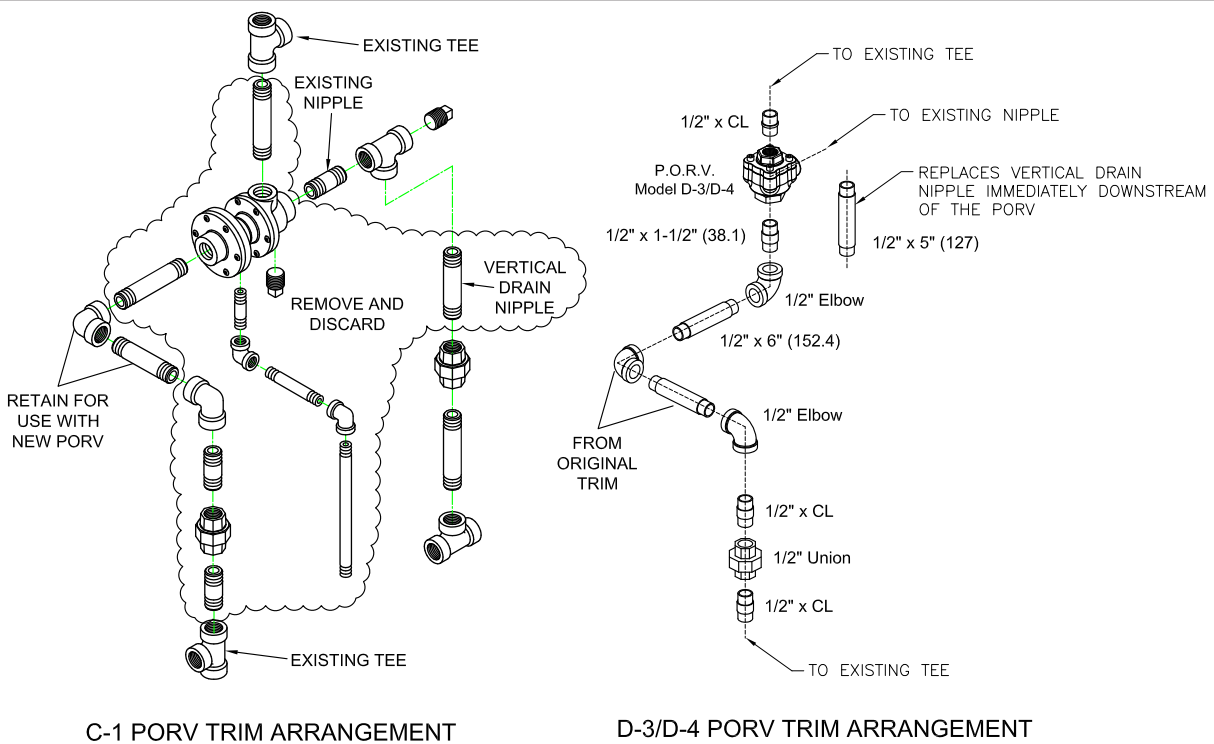

Figure 4 - Replacement PORV for Straight Through Horizontal Valves, 8"

**THIS PAGE
INTENTIONALLY
LEFT BLANK**