



GUARDIAN

FIRE EQUIPMENT, INC.
MIAMI, FL

Ph. 800.327.6584 • Fax 800.827.3869

DETAIL AND SUBMITTAL SHEET

5100 Series - Gate Valves

Project/Location: _____

Date: _____

Architect/Engineer: _____

Qty: _____

Contractor: _____

Appropriate Selection

Female x Male Gate Valves (Non-Rising Stem) - Used on dry systems as fire hose outlet connections and on pump test manifolds. Female NPT inlet x Male hose thread outlet, solid wedge disc with tapered seats, 300 PSI, cast brass, UL listed/FM approved.

Model No.	Size	A	B (Open)	C	D	E
<input type="checkbox"/> 5110	2 1/2" x 2 1/2"	5 1/8"	9 3/4"	4 3/4"	1 7/8"	3 1/2"
<input type="checkbox"/> 5115	3" x 2 1/2"	5 1/8"	9 3/4"	4 5/8"	2 7/8"	3 1/2"

Optional Finish: -B Polished Brass -C Rough Chrome Plated -D Polished Chrome Plated

Threads: NST Other _____

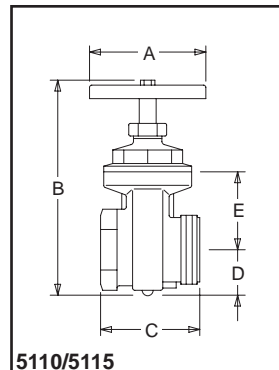

Female x Male Gate Valve (Non-Rising Stem) - Used on dry systems as fire hose outlet connections and on pump test manifolds. Female hose thread swivel inlet x Male hose thread outlet, solid wedge disc with tapered seats, 300 PSI, cast brass, UL listed/FM approved.

Model No.	Size	A	B (Open)	C	D	E
<input type="checkbox"/> 5120	2 1/2" x 2 1/2"	5 1/8"	9 3/4"	5 1/4"	1 7/8"	3 1/2"

Optional Finish: -B Polished Brass -C Rough Chrome Plated -D Polished Chrome Plated

Threads: NST Other _____

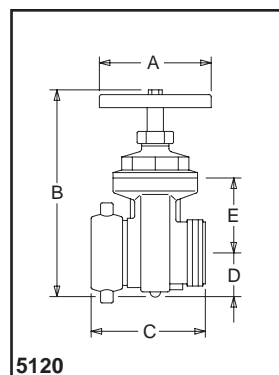

Caps with Chains - Used to protect hose thread outlets on valves and hydrants.

Cast brass caps (pin lugs)* or red plastic caps (rocker lugs).

Model No.	Size	Type
<input type="checkbox"/> 5515	1 1/2"	Brass
<input type="checkbox"/> 5515P	1 1/2"	Plastic
<input type="checkbox"/> 5525	2 1/2"	Brass
<input type="checkbox"/> 5525P	2 1/2"	Plastic

Threads:
 NST
 Other

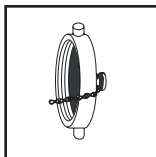

Optional Finish: -B Polished Brass -C Rough Chrome Plated
 -D Polished Chrome Plated

*Optional: -RL Rocker lugs

Reducer - Used to change outlet size. Rigid pin lug*, female x male threads.

Model No.	Size
<input type="checkbox"/> 3315	2 1/2" x 1 1/2"

Optional Finish:
 -B Polished Brass
 -C Rough Chrome Plated
 -D Polished Chrome Plated

*Optional: -RL Rocker lugs

Threads:
 NST
 Other

