

6100 Series Projecting Fire Dept. Inlet Connections

GUARDIAN
FIRE EQUIPMENT, INC.

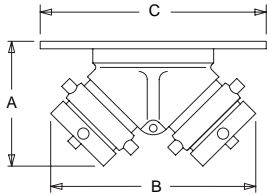

6114



6124/6126

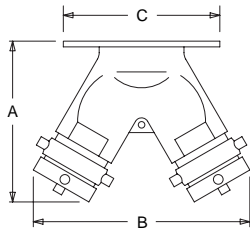

6136

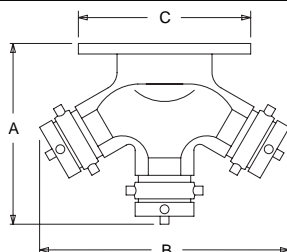

Function

- Used as auxiliary connections through which the fire department can pump water to supplement existing water supplies
- Provides 250 GPM flow (minimum), per 2¹/₂" inlet

Features/Components

- **Two and three-way** inlet connections feature clappered brass bodies (straight pattern), with female hose thread swivel inlets and female NPT outlets
- **Standard components, all connections:**
Plugs with chains and identification plate
- Cast brass construction*, standard

*Optional brass finishes, add suffix to model no.

-B Polished; -C Rough Chrome Plated; -D Polished Chrome Plated

Two and Three-Way Connections

Model No.	Size	Clappers	A	B	C
6114	4" x 2 ¹ / ₂ " x 2 ¹ / ₂ "	1	5 ⁷ / ₈ "	8 ¹ / ₈ "	10"
6124	4" x 2 ¹ / ₂ " x 2 ¹ / ₂ "	2	7 ⁵ / ₈ "	10 ¹ / ₂ "	10"
6126	6" x 2 ¹ / ₂ " x 2 ¹ / ₂ "	2	8"	10 ¹ / ₂ "	11 ¹ / ₄ "
6136	6" x 2 ¹ / ₂ " x 2 ¹ / ₂ " x 2 ¹ / ₂ "	3	11 ¹ / ₄ "	13 ³ / ₄ "	11 ¹ / ₄ "

Identification Plate Lettering:

- AUTO SPKR
- AUTO SPKR & STANDPIPE
- STANDPIPE
- DRY STANDPIPE

Notes

- Always specify hose threads and identification plate lettering
- Contact factory for current UL listing/FM approvals and special requirements