



TRIM DIAGRAM

**MODEL VXD
DOUBLE INTERLOCK WITH
ELECTRIC/PNEUMATIC
RELEASE 2-1/2"**

The Viking Corporation, 210 N Industrial Park Drive, Hastings MI 49058
Telephone: 269-945-9501 Technical Services: 877-384-5464 Fax: 269-818-1680 Email: techsvcs@vikingcorp.com
Visit the Viking website for the latest edition of this technical data page.



WARNING: Cancer and Reproductive Harm-
www.P65Warnings.ca.gov

General Notes:

- Valve must be trimmed as shown. Any deviation from trim size or arrangement may affect the proper operation of the valve.
- All pipe, 3/4" (20 mm) and smaller, shall be galvanized steel except when other materials are specified in the Technical Data for the system used.
- Viking uses ASME fitting designations. Tees shall be called out in the following order: 1 - Largest outlet on run; 2 - Smaller outlet on run; 3 - Branch size.

NOTE: Viking uses ASME fitting designations. Tee's shall be called out in the following manner: 1-Largest outlet on run; 2-Smaller outlet on run; 3-Branch size.

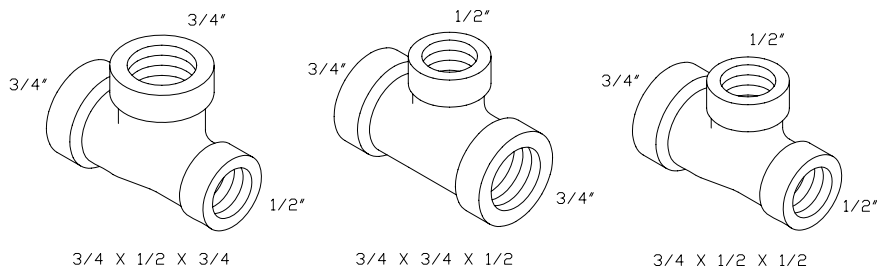



TRIM DIAGRAM

MODEL VXD DOUBLE INTERLOCK WITH ELECTRIC/PNEUMATIC RELEASE 2-1/2"

The Viking Corporation, 210 N Industrial Park Drive, Hastings MI 49058
 Telephone: 269-945-9501 Technical Services: 877-384-5464 Fax: 269-818-1680 Email: techsvcs@vikingcorp.com
 Visit the Viking website for the latest edition of this technical data page.

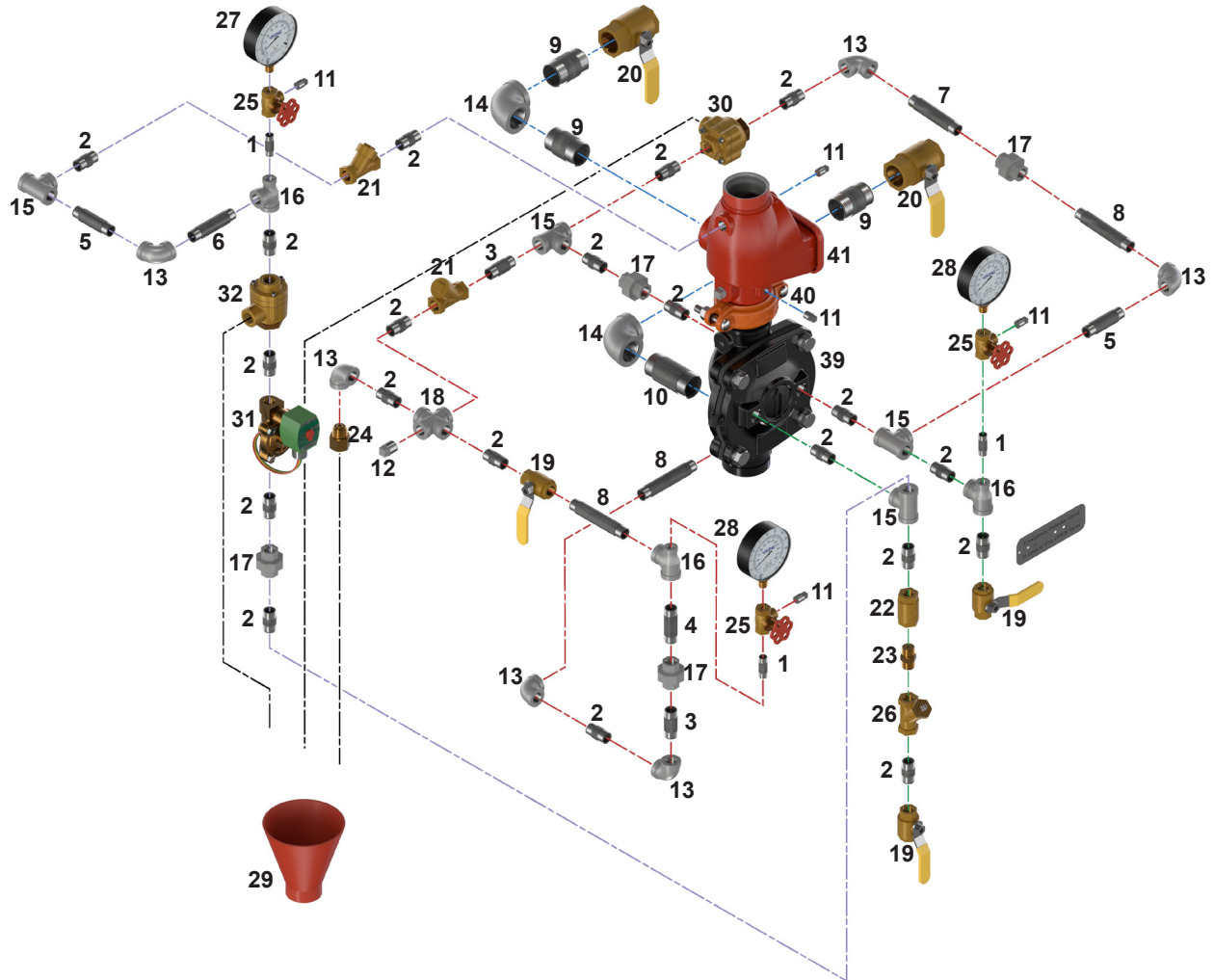

#	Description/Specification	Metric Length	Quantity
1	1/4" X 1-1/2"	38 mm	3
2	1/2" X 1-1/2"	38 mm	20
3	1/2" X 2"	51 mm	2
4	1/2" X 2-1/2"	64 mm	1
5	1/2" X 3"	76 mm	2
6	1/2" X 3-1/2"	89 mm	1
7	1/2" X 4"	102 mm	1
8	1/2" X 4-1/2"	115 mm	3
9	1-1/4" X 2-1/2"	64 mm	3
10	1-1/4" X 3-1/2"	89 mm	1
11	1/4" plug	--	5
12	1/2" plug	--	1
13	1/2" elbow	--	6
14	1-1/4" elbow	--	2
15	1/2" tee	--	4
16	1/2" X 1/4" X 1/2" tee	--	3
17	1/2" union	--	4
18	1/2" cross	--	1

#	Description/Specification	Metric Length	Quantity
19	1/2" Ball Valve	--	3
20	1-1/4" Ball Valve	--	2
21	1/2" Swing check valve	--	2
22	1/2" Inline check valve	--	1
23	1/2", 1/8" Restriction orifice	--	1
24	1/2", 1/8" Restriction orifice	--	1
25	1/4" Side outlet valve	--	3
26	1/2" Strainer	--	1
27	Air pressure gauge	--	1
28	Water pressure gauge	--	2
29	Drain Cup	--	1
30	PORV Assembly	--	1
31	Solenoid valve	--	1
32	Pneumatic actuator	--	1
39	2-1/2" Deluge valve	--	1
40	2-1/2" Grooved coupling	--	1
41	2-1/2" Check valve	--	1